

PAA HEAT KIT SETUP – PAR Controller

The PAA A-coil requires function settings to be set to adjust heat pump switchover point. The Mitsubishi PAA control box can control 1 or 2 stage furnace operation.

THERMOSTAT BUTTONS

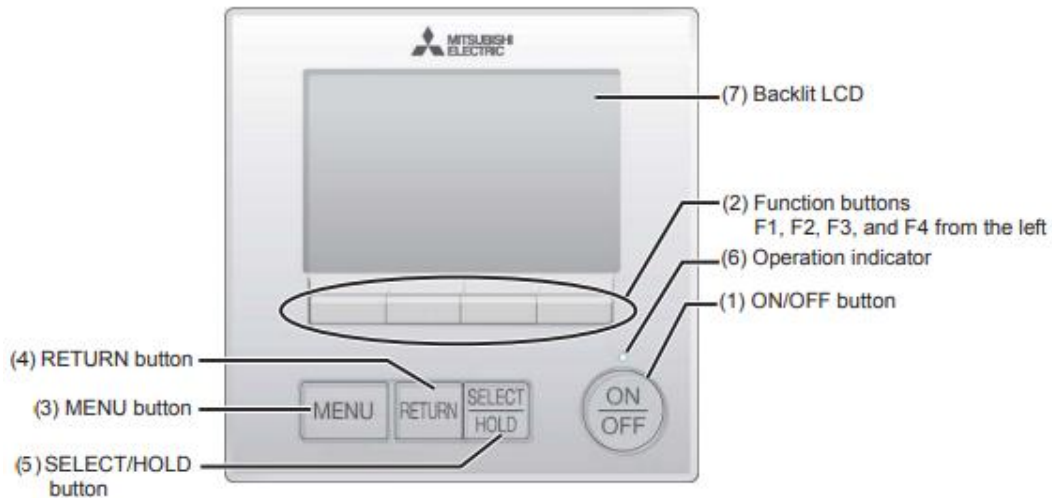

1. TURN SYSTEM ON OR OFF
2. USE F1/F2/F3/F4 FUNCTION BUTTONS TO SELECT INFORMATION DISPLAYED ON BOTTOM EDGE OF SCREEN
 - a. TEMP SET, FAN SPEED, CURSOR ETC
3. MAIN MENU
4. RETURN TO PREVIOUS SCREEN
5. PRESS TO 'SELECT' OR ACCEPT SELECTION
6. LIT DURING OPERATION

THERMOSTAT SENSING LOCATION – MODE 2

The icon on the thermostat will indicate where the room temperature is read from. Typical installs will have the room temperature read from the built-in thermistor on the remote controller. Item 17 in the image below shows the room temperature sensing location.

Full mode

* All icons are displayed for explanation.

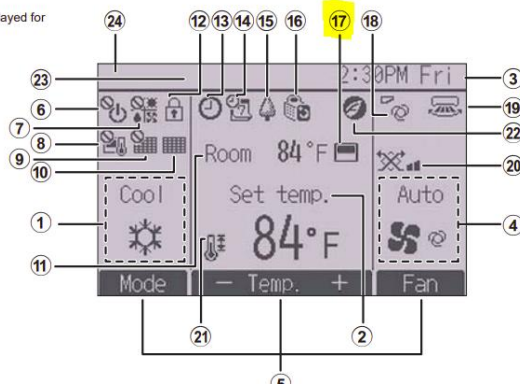

Appears when the built-in thermistor on the remote controller is activated to monitor the room temperature (17).



appears when the thermistor on the indoor unit is activated to monitor the room temperature.

REF ADDRESS	UNIT NO.	MODE	SETTING	Description
0	Grp.	2	3	Thermostat Sensing location (Thermostat)

SWITCHOVER BALANCE POINTS – MODE 8 AND 10

Select the lowest temperature you want the heat pump to operate. The heat pump may switch over earlier if the heat pump cannot keep up to the load in the house.

INDOOR UNIT SETTINGS			
MODE 8	MODE 10	STANDARD HP BALANCE POINT	HYPER HEAT H2i BALANCE POINT
1	1	-13° C (9° F)	-24° C (-11° F)
1	2	-10° C (14° F)	-13° C (9° F)
2	1	COOLING ONLY/FURNACE ONLY	COOLING ONLY/FURNACE ONLY
2	2	-7° C (19° F)	-10° C (14° F)
3	1	-3° C (27° F)	-3° C (27° F)
3	2	0° C (32° F) (default)	0° C (32° F) (default)

ERV CONNECTION

MODE	SETTING	Description
26	2	TURN ON FAN WITH CNER INPUT (WIRING HARNESS REQUIRED)

SWITCHOVER TIME DELAY

Switchover Time Delay begins to count when setpoint and room temperature are 0.5° C apart. Switchover based on time delay will only happen if two criteria are met

1. Room temperature has not increased within the time delay by 0.5° C or more
 - a. Timer resets if room temperature increases
2. Room temperature and setpoint are 1.5° C apart

TIMER BEGINS WHEN: $T_{setpoint} - T_{room} \geq 0.5^{\circ} C$

FURNACE STARTS: $T_{setpoint} - T_{room} \geq 1.5^{\circ} C$ AND Time Delay is reached

REQUEST CODE	TIME DELAY:
390	DISPLAY OF CURRENT SETTING
391	24 MIN
394	29 MIN

SINGLE STAGE VS 2 STAGE FURNACE

MODE	SETTING	Description
23	1	SINGLE STAGE (SINGLE INPUT) FURNACE
23	2	TWO STAGE FURNACE

FAN CONTROL

MODE	SETTING	Description
25	1	HEATING - FAN ON CONSTANT
25	2	HEATING - FAN CYCLES WITH HEAT CALL
27	1	COOLING – FAN ON CONSTANT
27	2	COOLING – FAN CYCLES WITH COOLING CALL

CHANGING THE FUNCTION SETTINGS

Accessing the Function Setting Screen

The system must be turned off using the on/off button before making these changes.

You will need the settings password: 9999

When settings are completed, press the **Select** button to send data to the system. When complete the screen will return to the Function Setting Screen.

This is found under Menu → service menu (9999 password) → settings menu → function setting

1. Press Menu
2. Use Function Buttons to move cursor to highlight **Service Menu** (right side)
 - a. Press Select

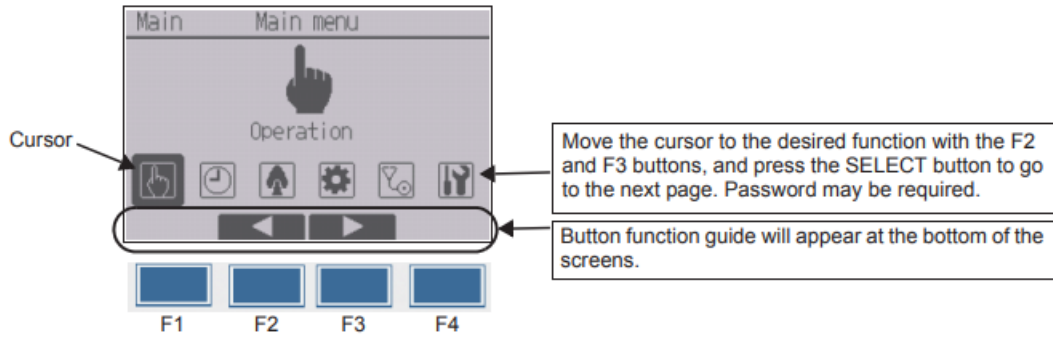

3. Use Function Buttons to enter service password **9999**
 - a. Press Select
4. Use Function Buttons to find **Settings Menu**
 - a. Press Select
5. Use Function Buttons to find **Function Setting**
 - a. Press Select

Function Setting Screen

6. Ref Address: 0
 - a. If controlling multiple units with one controller use the address of the specific unit.
Factory setting for one unit is 0
7. Unit no. Grp. Or All
 - a. See table in Function Setting Quick Set Guide section above

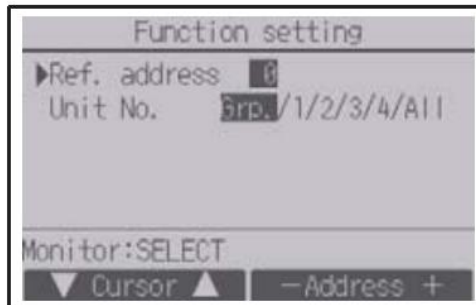

8. Referencing the Quick Set Guide use the cursor to find the desired Mode number
 - a. Use cursor to change the setting 1/2/3 to desired selections
 - b. Press Select

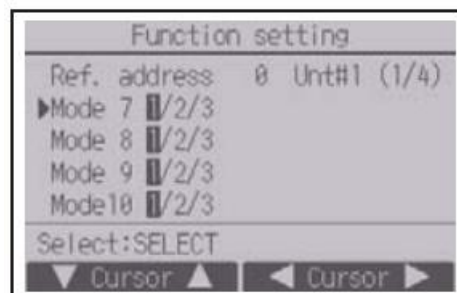

CHANGING THE REQUEST CODES

Accessing the Function Setting Screen

You will need the settings password: 9999

When settings are completed, press the **Select** button to send data to the system. When complete the screen will return to the Function Setting Screen.

This is found under Menu → service menu (9999 password) → settings menu → check → request codes

Other Information

Administrator Password

(initial setting): **0000**

Reset Administrator Password: Press and hold F1 for 10 seconds in the admin password screen

FUNCTION SETTING QUICK SET GUIDE

Using the procedures outlined below the table you will need to set these settings to activate the auxiliary heater control and change thermostat sensing location.

REF ADDRESS	UNIT NO.	MODE	SETTING	Description
0	Grp.	2	3	Thermostat Sensing location (Thermostat)
0	All	11	2	Heater Control Active
0	All	23	2	Heater during error & defrost